



FUKUCOM COMPANY LTD.

福 靈 有 限 公 司

FLAT P, 3/F., EVEREST INDUSTRIAL CENTRE, 396 KWUN TONG ROAD,
KWUN TONG, KOWLOON, HONG KONG.

TEL: 852-2790 0314 FAX: 852-2790 0206

1N4148W

Silicon Epitaxial Planar Switching Diode

Features

- SOD-123 package
- Fast switching
- These diodes are also available in other case style including the DO-35 case with the type designation 1N4148, the MiniMELF case with the type designation LL4148 and the MicroMELF case with the type designation MCL4148.

PINNING

PIN	DESCRIPTION
1	Cathode
2	Anode

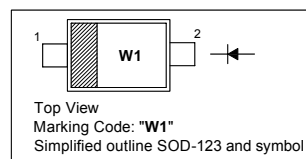

Absolute Maximum Ratings (T_a = 25 °C)

Parameter	Symbol	Value	Unit
Peak Reverse Voltage	V _{RM}	100	V
Reverse Voltage	V _R	75	V
Average Rectified Forward Current	I _{F(AV)}	150	mA
Non-repetitive Peak Forward Surge Current at t = 1 μs	I _{FSM}	2	A
Power Dissipation	P _{tot}	400	mW
Thermal Resistance from Junction to Ambient Air	R _{θJA}	312	°C/W
Junction Temperature	T _J	150	°C
Storage Temperature Range	T _{stg}	- 65 to + 150	°C

Electrical Characteristics (T_a = 25°C)

Parameter	Symbol	Max.	Unit
Forward Voltage at I _F = 10 mA	V _F	1	V
Reverse Current at V _R = 20 V at V _R = 75 V at V _R = 20 V, T _J = 150 °C	I _R	25 5 50	nA μA μA
Total Capacitance at V _R = 0 V, f = 1 MHz	C _{tot}	4	pF
Reverse Recovery Time at I _F = 10 mA to I _R = 1 mA, V _R = 6 V, R _L = 100 Ω	t _{rr}	4	ns

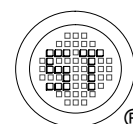

Dated : 15/06/2009



FUKUCOM COMPANY LTD.

福靈有限公司

FLAT P, 3/F., EVEREST INDUSTRIAL CENTRE, 396 KWUN TONG ROAD,
KWUN TONG, KOWLOON, HONG KONG.

TEL: 852-2790 0314 FAX: 852-2790 0206

1N4148W

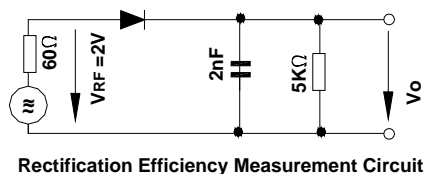

Rectification Efficiency Measurement Circuit

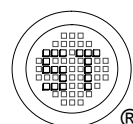
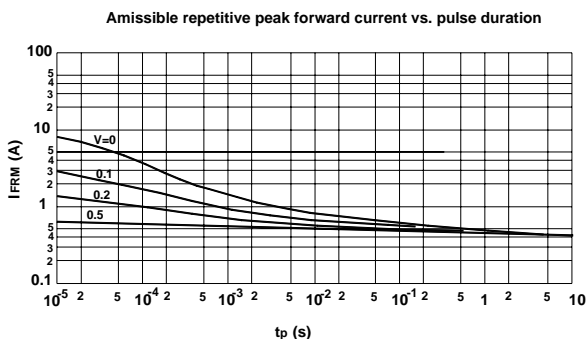
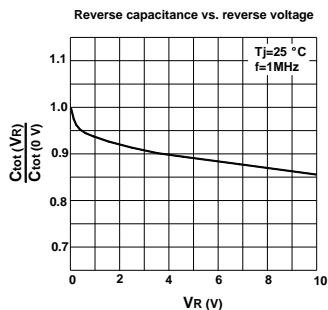
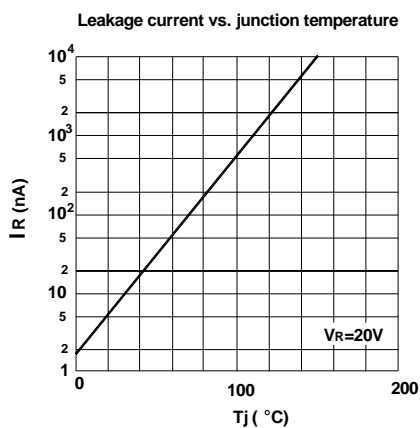
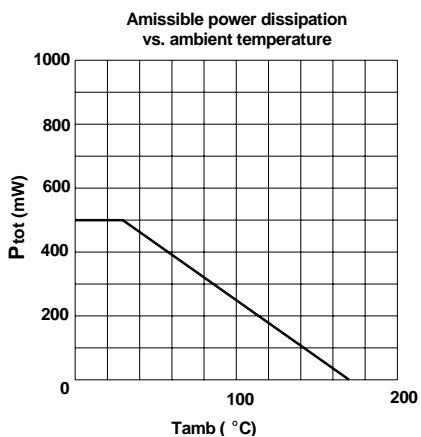
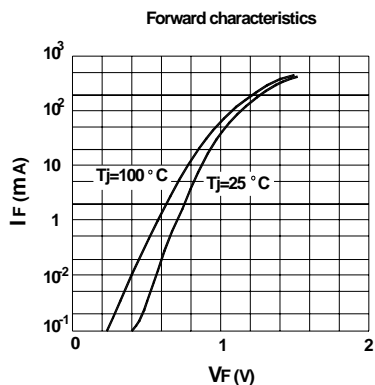

Dated : 15/06/2009



FUKUCOM COMPANY LTD.

福 靈 有 限 公 司

FLAT P, 3/F., EVEREST INDUSTRIAL CENTRE, 396 KWUN TONG ROAD,
KWUN TONG, KOWLOON, HONG KONG.

TEL: 852-2790 0314 FAX: 852-2790 0206

1N4148W

PACKAGE OUTLINE

Plastic surface mounted package; 2 leads

SOD-123

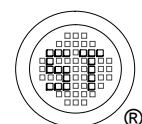
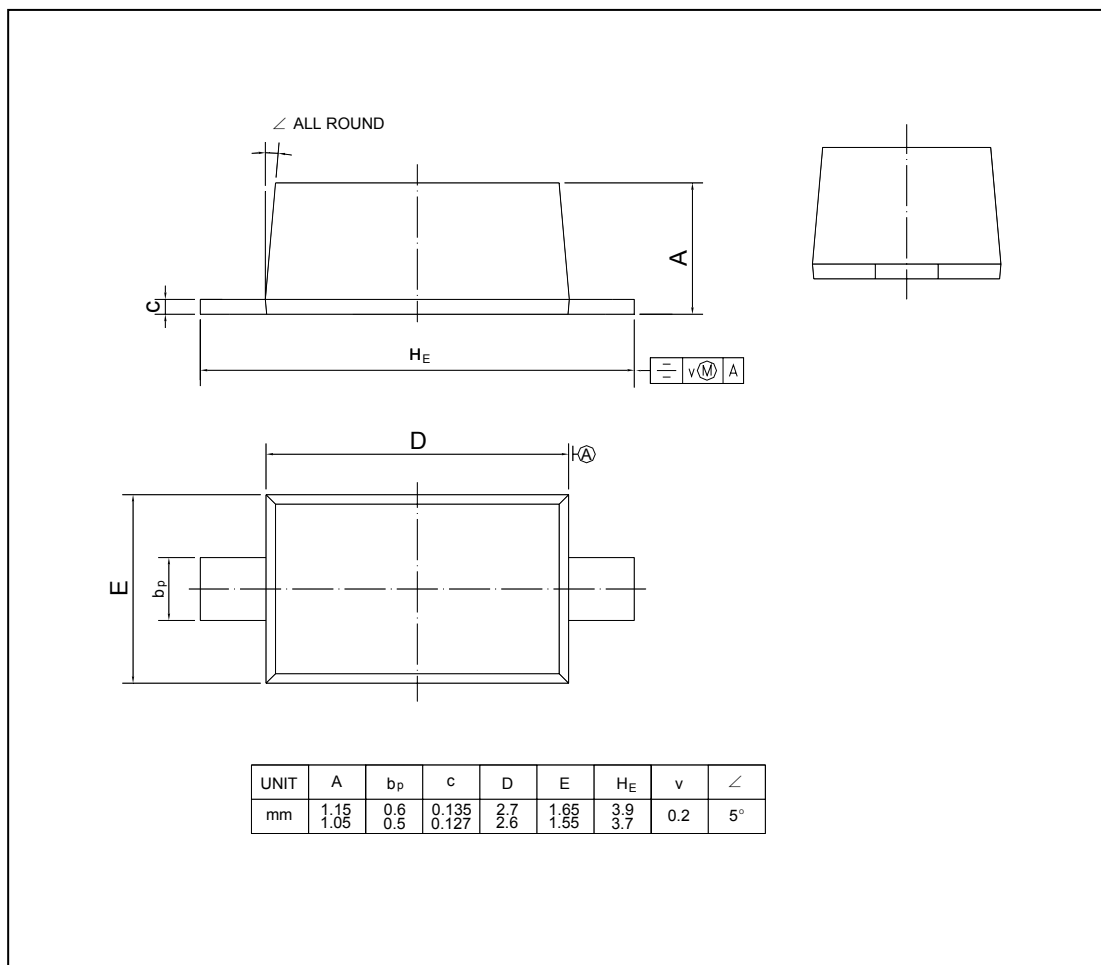

Dated : 15/06/2009