



FUKUCOM COMPANY LTD.

福 靈 有 限 公 司

FLAT P, 3/F., EVEREST INDUSTRIAL CENTRE, 396 KWUN TONG ROAD,
KWUN TONG, KOWLOON, HONG KONG.

TEL: 852-2790 0314 FAX: 852-2790 0206

MM5Z3B0~MM5ZB47

Zener Voltage Regulators

Features

- Standard Zener Breakdown Voltage Range
3 V to 47 V
- Steady State Power Rating of 200 mW
- Tolerance $\pm 2\%$

PINNING

PIN	DESCRIPTION
1	Cathode
2	Anode

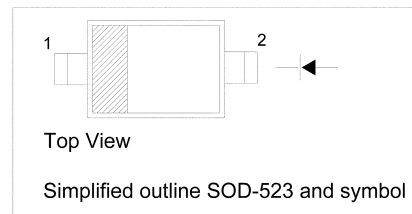

Absolute Maximum Ratings ($T_j = 25^\circ\text{C}$)

Parameter	Symbol	Value	Unit
Total Device Dissipation FR-5 Board at $T_A = 25^\circ\text{C}$	P_{tot}	200	mW
Junction and Storage Temperature Range	T_j, T_{stg}	-65 to +150	$^\circ\text{C}$

Characteristics at $T_{amb} = 25^\circ\text{C}$

Parameter	Symbol	Max.	Unit
Forward Voltage at $I_F = 10\text{ mA}$	V_F	0.9	V

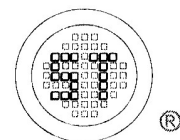

SEMTECH

Dated : 03/05/2006



FUKUCOM COMPANY LTD.

福 靈 有 限 公 司

FLAT P, 3/F., EVEREST INDUSTRIAL CENTRE, 396 KWUN TONG ROAD,
KWUN TONG, KOWLOON, HONG KONG.

TEL: 852-2790 0314 FAX: 852-2790 0206

MM5Z3B0~MM5ZB47

Type	Marking Code	Zener Voltage ¹⁾				Zener Impedance			Leakage Current		θV_z (mV/k) @ I_{zT}		C @ $V_R=0$ f=1MHz pF
		V_{zT} (V)			@ I_{zT}	Z_{zT}	Z_{zK}	at I_{zK}	I_R	@ V_R	Min.	Max.	
		Min.	Nom.	Max.	mA	Ω	Ω	mA	μA	V			
MM5Z3B0	FR	2.94	3	3.06	5	100	1000	1	50	1	-3.5	0	450
MM5Z3B3	FX	3.23	3.3	3.37	5	95	1000	1	20	1	-3.5	0	450
MM5Z3B6	FY	3.52	3.6	3.68	5	90	1000	1	10	1	-3.5	0	450
MM5Z3B9	FZ	3.82	3.9	3.98	5	90	1000	1	5	1	-3.5	-2.5	450
MM5Z4B3	HA	4.21	4.3	4.39	5	90	1000	1	5	1	-3.5	0	450
MM5Z4B7	HB	4.6	4.7	4.8	5	80	800	1	2	1	-3.5	0.2	260
MM5Z5B1	HC	4.99	5.1	5.21	5	60	500	1	2	1.5	-2.7	1.2	225
MM5Z5B6	HD	5.48	5.6	5.72	5	40	200	1	1	2.5	-2.0	2.5	200
MM5Z6B2	HE	6.07	6.2	6.33	5	10	100	1	1	3.0	0.4	3.7	185
MM5Z6B8	HF	6.66	6.8	6.94	5	15	160	1	0.5	3.5	1.2	4.5	155
MM5Z7B5	HH	7.35	7.5	7.65	5	15	160	1	0.5	4.0	2.5	5.3	140
MM5Z8B2	HJ	8.03	8.2	8.37	5	15	160	1	0.5	5.0	3.2	6.2	135
MM5Z9B1	HK	8.91	9.1	9.29	5	15	160	1	0.5	6.0	3.8	7.0	130
MM5ZB10	HM	9.8	10	10.2	5	20	160	1	0.1	7.0	4.5	8.0	130
MM5ZB11	HN	10.78	11	11.22	5	20	160	1	0.1	8.0	5.4	9.0	130
MM5ZB12	HP	11.76	12	12.24	5	25	80	1	0.1	9.0	6.0	10	130
MM5ZB13	HR	12.98	13.25	13.52	5	30	80	1	0.1	10	7.0	11	120
MM5ZB15	HX	14.7	15	15.3	5	30	80	1	0.1	11	9.2	13	110
MM5ZB16	HY	15.87	16.2	16.53	2	40	80	1	0.1	12	10.4	14	105
MM5ZB18	HZ	17.64	18	18.36	2	45	80	1	0.1	13	12.4	16	100
MM5ZB20	JA	19.6	20	20.4	2	55	100	1	0.1	15	14.4	18	85
MM5ZB22	JB	21.56	22	22.44	2	55	100	1	0.1	17	16.4	20	85
MM5ZB24	JC	23.71	24.2	24.69	2	70	120	1	0.1	19	18.4	22	80
MM5ZB27	JD	26.46	27	27.54	2	80	300	1	0.1	21	21.4	25.3	70
MM5ZB30	JE	29.4	30	30.6	2	80	300	1	0.1	23	24.4	29.4	70
MM5ZB33	JF	32.34	33	33.66	2	80	300	1	0.1	25	27.4	33.4	70
MM5ZB36	JH	35.28	36	36.72	2	90	500	1	0.1	27	30.4	37.4	70
MM5ZB39	JJ	38.22	39	39.78	2	130	500	1	2	30	33.4	41.2	45
MM5ZB43	JK	42.14	43	43.86	1	150	500	1	2	33	37.6	46.6	40
MM5ZB47	JM	46.06	47	47.94	1	170	500	1	2	36	42.0	51.8	40

¹⁾ Tested with pulses $t_p = 20$ ms.

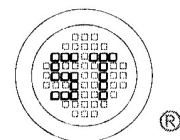

SEMTECH

Dated : 03/05/2006



FUKUCOM COMPANY LTD.

福 靈 有 限 公 司

FLAT P, 3/F., EVEREST INDUSTRIAL CENTRE, 396 KWUN TONG ROAD,
KWUN TONG, KOWLOON, HONG KONG.

TEL: 852-2790 0314 FAX: 852-2790 0206

MM5Z3B0~MM5ZB47

PACKAGE OUTLINE

Plastic surface mounted package; 2 leads

SOD-523

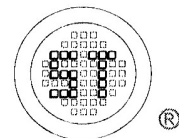
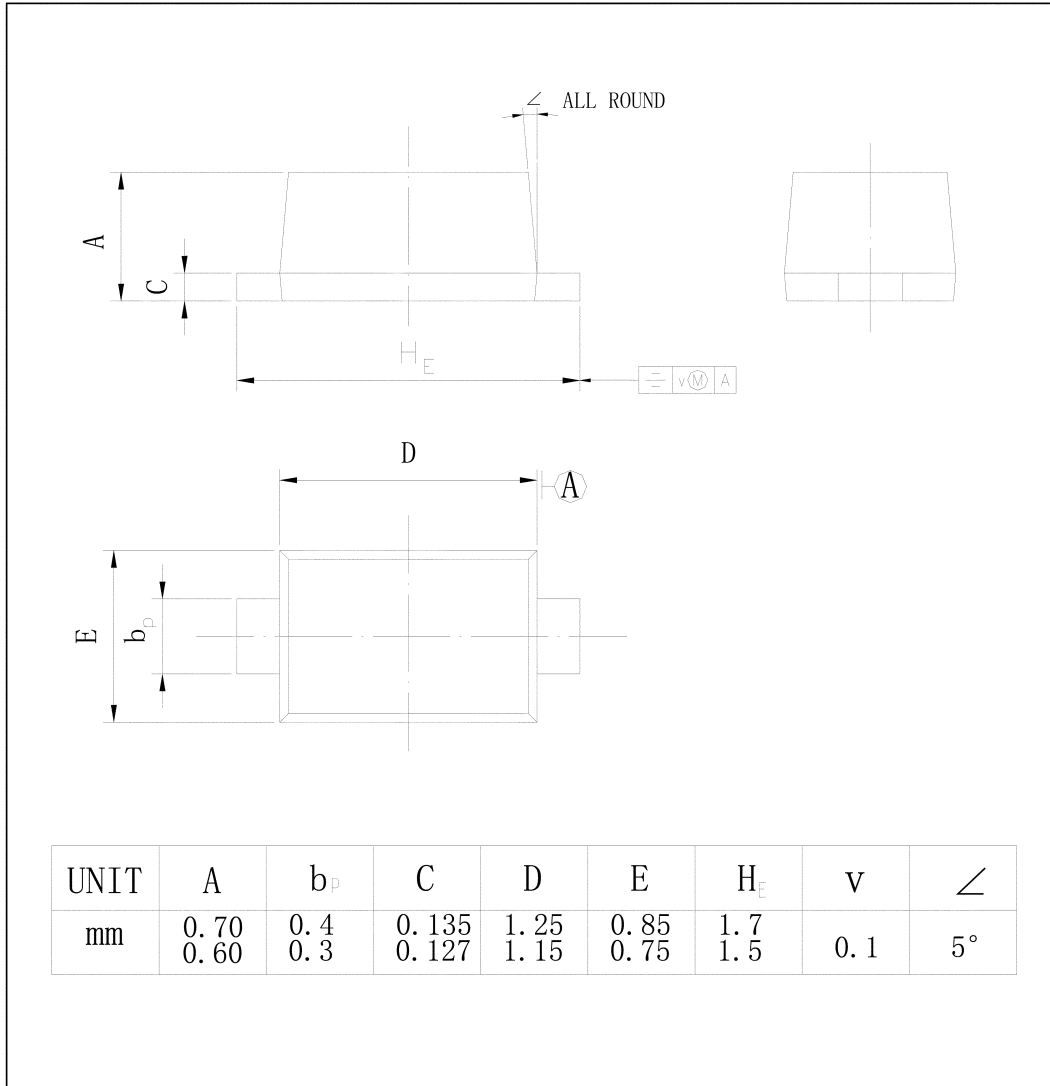

SEMTECH

Dated : 03/05/2006