



# FUKUCOM COMPANY LTD.

## 福靈有限公司

FLAT P, 3/F., EVEREST INDUSTRIAL CENTRE, 396 KWUN TONG ROAD,  
KWUN TONG, KOWLOON, HONG KONG.  
TEL: 852-2790 0314 FAX: 852-2790 0206

### 1N119WS

#### SILICON EPITAXIAL PLANAR DIODE

#### APPLICATIONS

- High speed switching

#### PINNING

PIN	DESCRIPTION
1	Cathode
2	Anode

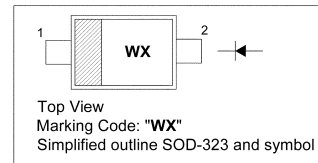

#### Absolute Maximum Ratings ( $T_a = 25\text{ }^\circ\text{C}$ )

Parameter	Symbol	Value	Unit
Peak Reverse Voltage	$V_{RM}$	85	V
Reverse Voltage	$V_R$	80	V
Average Forward Current	$I_O$	100	mA
Peak Forward Current	$I_{FM}$	300	mA
Non-repetitive Peak Forward Current ( $t = 1\text{ }\mu\text{s}$ )	$I_{FSM}$	4	A
Junction Temperature	$T_J$	125	$^\circ\text{C}$
Storage Temperature Range	$T_{stg}$	- 55 to + 125	$^\circ\text{C}$

#### Characteristics at $T_a = 25\text{ }^\circ\text{C}$

Parameter	Symbol	Max.	Unit
Forward Voltage at $I_F = 10\text{ mA}$ at $I_F = 100\text{ mA}$	$V_F$	0.8 1.2	V
Reverse Current at $V_R = 80\text{ V}$	$I_R$	0.1	$\mu\text{A}$
Capacitance between Terminals at $V_R = 0\text{ V}$ , $f = 1\text{ MHz}$	$C_T$	2	pF
Reverse Recovery Time at $V_R = 6\text{ V}$ , $I_F = 10\text{ mA}$ , $R_L = 50\text{ }\Omega$	$t_{rr}$	3	ns

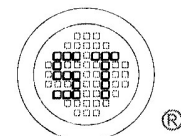

**SEMTECH**

Dated : 01/09/2005



FUKUCOM COMPANY LTD.

福靈有限公司

FLAT P, 3/F., EVEREST INDUSTRIAL CENTRE, 396 KWUN TONG ROAD,  
KWUN TONG, KOWLOON, HONG KONG.

TEL: 852-2790 0314 FAX: 852-2790 0206

## 1N119WS

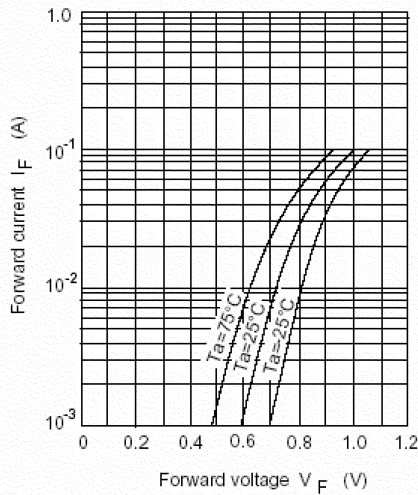

Fig.1 Forward current Vs. Forward voltage

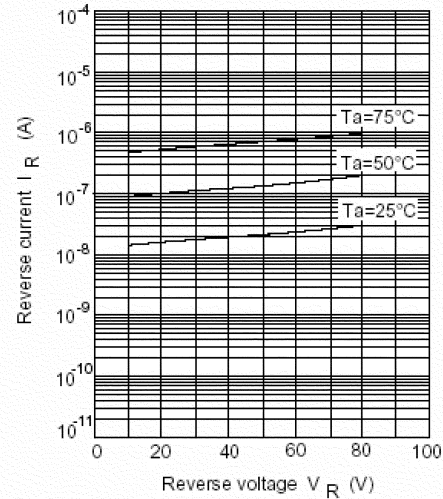

Fig.2 Reverse current Vs. Reverse voltage

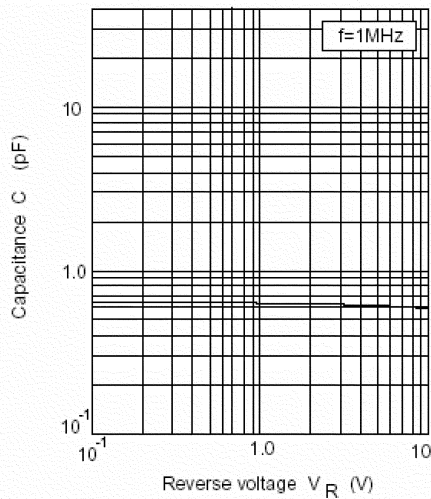
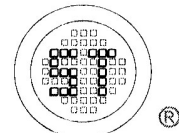

Fig.3 Capacitance Vs. Reverse voltage



SEMTECH

Dated : 01/09/2005



**FUKUCOM COMPANY LTD.**

**福 靈 有 限 公 司**

FLAT P, 3/F., EVEREST INDUSTRIAL CENTRE, 396 KWUN TONG ROAD,  
KWUN TONG, KOWLOON, HONG KONG.

TEL: 852-2790 0314 FAX: 852-2790 0206

## 1N119WS

### PACKAGE OUTLINE

Plastic surface mounted package; 2 leads

SOD-323

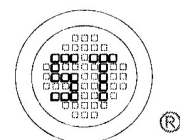
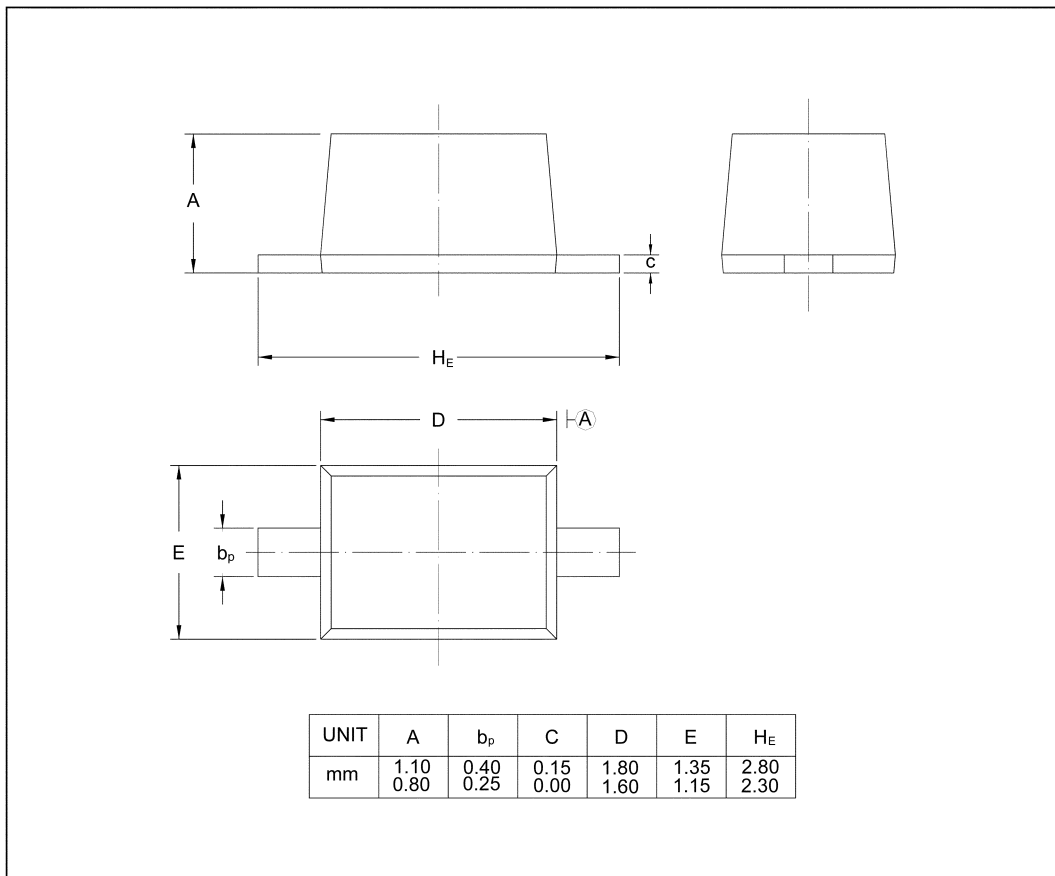

**SEMTECH**

Dated : 01/09/2005